

Vortex Paper Stock Solid Process Pumps

GIV



Applications

- 폐수처리 Waste Treatment
- 제지공업 Pulp and Paper
- 식품공정용 Food processing
- 농업용 Agriculture
- 광산용 Mining
- 제조공정용 Manufacturing Process

Feature

- ☑ 막히지 않음
Non-clog
- ☑ 뒤로 뽑는 설계
Back pull-out design
- ☑ 견고한 케이싱과 임펠러
Extra thick casing and impeller

Ratings

Capacity	UP to 5m ³ /min (1,321 US GPM)
Head	UP to 80m (262 ft)
Temperature	UP to 80°C (176°F)

Selection Chart

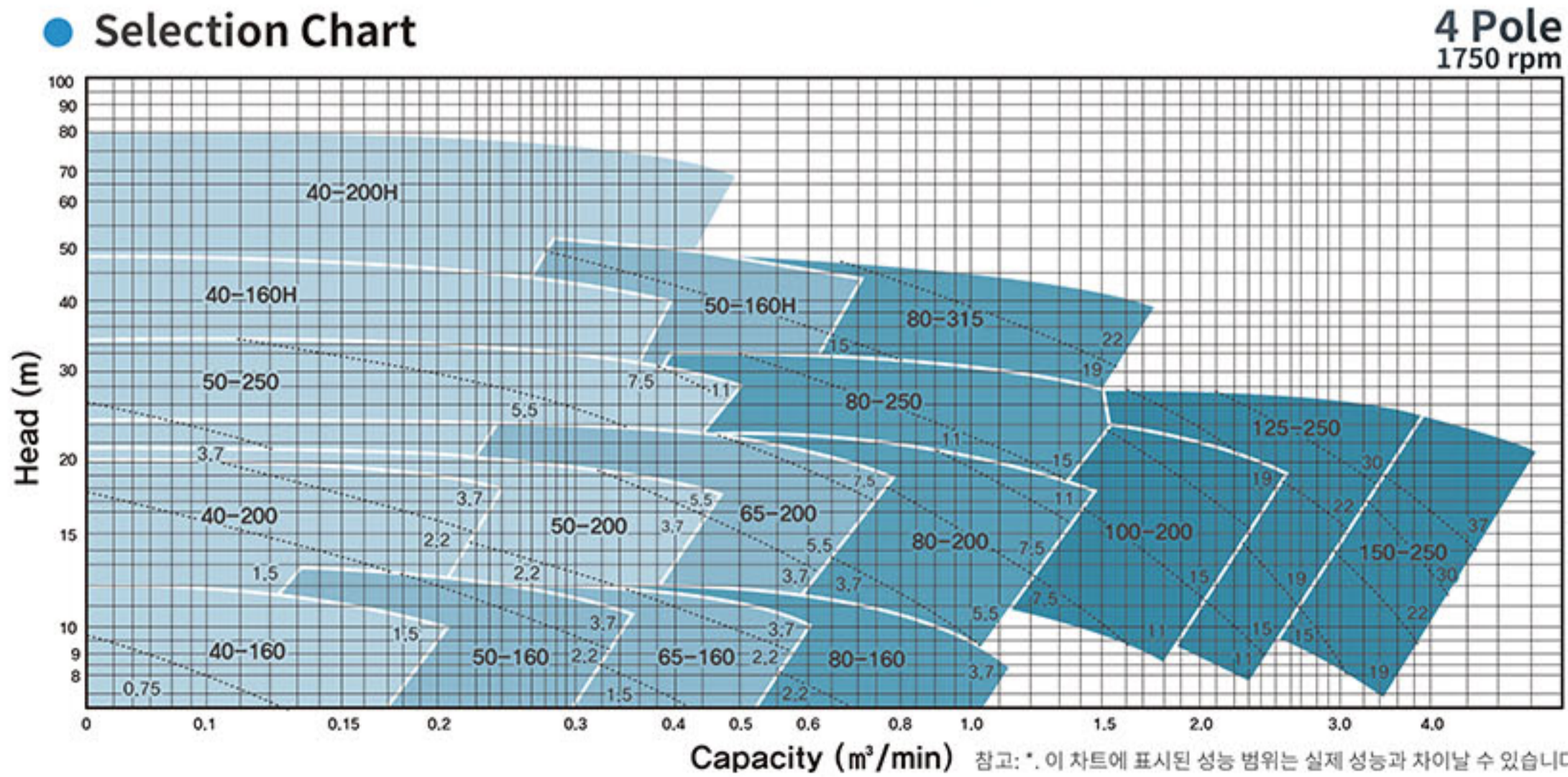

CW-Hydro, Inc.

Installation Dimension

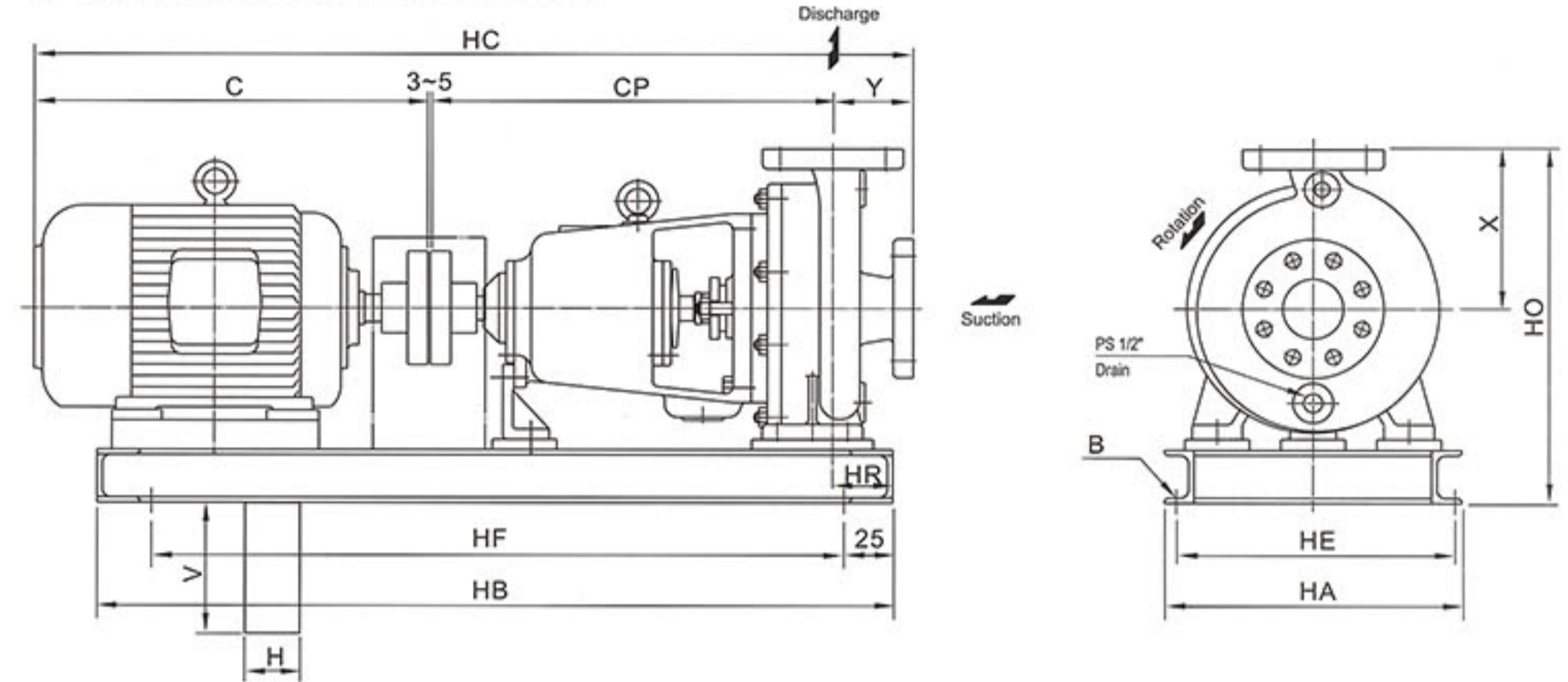

구분 규격	Pump and motor								Baseplate					Anchor Bolt			
	Disc.	Frame	kW	HC	C	CP	Y	X	HR	HF	HB	HE	HA	HO	B	H	V
40-160	40	90L	1.5	813	328	400	80	160	80	750	800	210	260	352	4-M16×315L	150	250
50-160	50	112S	2.2	841	356	400	80	160	80	750	800	210	260	352	4-M16×315L	150	250
65-160	65	112M	3.7	887	382	400	100	180	80	800	850	235	285	400	4-M16×315L	150	250
80-160	80	112M	3.7	887	382	510	100	200	90	900	950	235	285	420	4-M16×315L	150	250
40-200	40	112M	3.7	997	382	510	100	200	90	900	950	235	285	420	4-M16×315L	150	250
50-200	50	132S	5.5	1059	444	510	100	200	90	950	1000	235	285	420	4-M16×315L	150	250
65-200	65	132M	7.5	1097	482	510	125	200	90	1000	1050	235	285	420	4-M16×315L	150	250
80-200	80	160M	11	1243	593	520	125	225	95	1100	1150	290	340	465	4-M16×315L	150	250
50-250	50	160M	11	1223	593	500	125	225	95	1050	1100	290	340	465	4-M16×315L	150	250
80-250	80	160L	15	1267	637	500	125	280	110	1150	1200	370	420	580	4-M16×315L	150	250
100-200	100	160L	15	1287	637	520	125	225	95	1150	1200	315	365	500	4-M16×315L	150	250
80-315	80	180M	19	1327	649	550	125	280	110	1200	1250	370	420	580	4-M16×315L	150	250
125-250	125	200M	30	1403	708	550	140	280	110	1250	1300	370	420	580	4-M16×315L	150	250
150-250	150	200L	37	1442	747	550	140	280	110	1250	1300	370	420	605	4-M16×315L	150	250

참고: * 단위: mm / 이 카탈로그의 내용은 예고없이 변경 될 수 있습니다.

Parts List and Materials

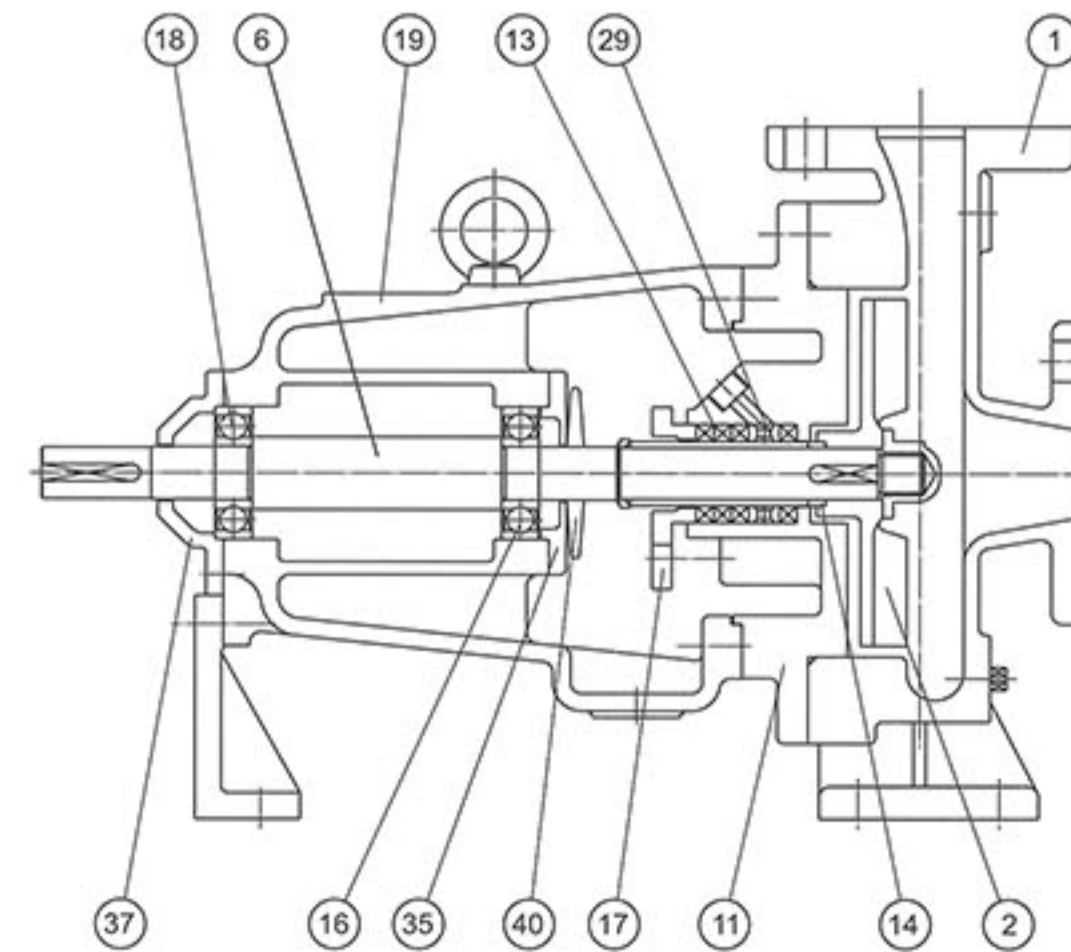

No	Name of part	METERIAL
1	Casing	GC200
2	Impeller	GC200
6	Shaft	SM45C
11	Stuffing Box Cover	TEFLON
13	Packing	TEFLON
14	Sleeve	GC200
16	Inboard Bearing	STEEL
17	Gland	GC200
18	Outboard Bearing	STEEL
19	Frame	GC200
29	Lantern Ring	TEFLON
35A	Inboard Bearing Cover	GC200
37	Outboard Bearing Cover	GC200
40	Deflector	NBR

참고: * 이외의 기타 자료는 요청시 제공됩니다.